



Instructions for use
CAPSULE COFFEE MACHINE

Návod k obsluze
KÁVOVAR NA KAPSLE

Návod na obsluhu
KÁVOVAR NA KAPSULY

Használati útmutató
KAPSZULÁS KÁVÉFŐZŐ

Instrukcja obsługi
EKSPRES DO KAWY
NA KAPSUŁKI

CAPSULE COFFEE MACHINE



ES 750 G | ES 750 B

CAPSULE COFFEE MACHINE

TABLE OF CONTENTS

5	CATLER RECOMMENDS SAFETY FIRST
9	MEET YOUR COFFEE MACHINE
9	Coffee Machine and Its Accessories
10	Control panel
11	Supplied holders
12	Before first use
12	Filling the tank
12	Filling the Milk Container
13	Steam jet
13	Using the Stand
14	USING YOUR COFFEE MACHINE
14	Rinsing the coffee machine
14	Using the Coffee Machine
15	Preparation of Coffee with Milk (Pods)
16	Manual Milk Frothing
16	Automatic Shutdown
16	Manual shutdown
16	Refilling the Water Tank
17	ADVANCED COFFEE MACHINE SETTINGS
17	Coffee Volume Adjustment
17	Milk Volume Adjustment
17	Restoring Factory Default
18	CARE AND CLEANING
18	Automatic cleaning
18	Holder and strainer
18	Drip tray and grate
18	Water tank
18	Coffee maker
19	Cleaning the Milk Container
19	Cleaning the Steam Jet
20	Descaling
20	Storage
21	TROUBLESHOOTING



Congratulations

on the purchase of your coffee machine.

CATLER RECOMMENDS SAFETY FIRST

We understand the importance of safety and that is why we put your safety first from the initial design concept to the production itself. Nevertheless, please be careful and follow the instructions below when using this appliance.

- This appliance may be used by children aged 8 years and older, provided they are supervised or have been instructed in the safe use of the appliance and understand the potential dangers.
- Children must not play with the appliance.
- Cleaning and maintenance performed by the user must not be performed by children unless they are older than 8 years of age and under supervision.
- Keep the appliance and its supply out of the reach of children under 8 years of age.
- This appliance may be used by persons with physical, sensory or mental impairments or by inexperienced persons, if they are properly supervised or have been informed about how to use the appliance in a safe manner and understand the potential dangers.
- If the power cord is damaged, have it replaced by a qualified service centre to prevent hazardous situations. It is forbidden to use the appliance with the power cord damaged.

- This appliance is designed for household use. It is also suitable for personal non-commercial use in spaces such as:
 - kitchenettes in stores, offices and other workplaces;
 - spaces in agriculture;
 - hotel, motels and other residential areas for guests;
 - bed and breakfast establishments.
- The appliance must not be immersed in water during cleaning.

WARNING: Avoid spilling on the plug.

- Clean surfaces that come into contact with water according to the instructions in this manual.

WARNING: There is a risk of injury if used incorrectly.

- The surface of the heating element contains residual heat after use.
- The appliance must not be placed in a cabinet when in use.

- Before connecting the appliance to a power socket, check that the nominal voltage on the appliance's rating label matches the electrical voltage in the socket.
- Connect the appliance only to a grounded socket. For safety reasons, we do not recommend using adaptors or extension cables.
- Do not place the appliance on windowsills, sink drip tray or unstable surfaces. Always place the appliance on a stable, flat and dry surface.
- Do not place the appliance on electric or gas cooker or in the vicinity of naked flame.
- Never use the appliance in the near vicinity of a bath, shower or swimming pool.
- The appliance is designed for making coffee. Use the appliance only for its intended purpose.
- Do not use the product outdoors.
- Use the appliances according to the instructions in this user's manual. Failure to do so may result in injury, damage to the appliance, or a hazardous situation.
- During operation, a clear space of at least 15 cm must be left around and above the appliance to ensure sufficient air circulation.
- Do not use the top surface of the appliance to store other items.
- Fill the water tank with clean cold water. Do not pour heated water or other liquids into it or insert any objects into it.
- Before switching on the appliance, check that:
 - the drip tray together with the grid is installed in position;
 - the water tank is filled with a sufficient amount of water and is properly installed in position. The water level must not exceed the maximum mark.
- Never use the appliance when the water tank is empty. There is a risk of damage to the appliance.
- Take great care when operating the appliance to avoid scalding with hot water or steam.
- When using the appliance, check the water level in the water tank regularly. If the water level drops below the minimum mark, refill the tank according to the instructions in this manual.
- Above the adapter inside the appliance there is a sharp needle which is used to pierce the capsule during use. Take extra care not to cut yourself on it. Do not put your hands inside the appliance when the holder is removed.
- Take great care when handling a drip tray full of water. The water can be hot and there is a risk of scalding or burns.
- Do not move the appliance with a cup of coffee placed on the drip tray grate or with cups placed on the surface designed to heat them up.
- Ensure that the power cord does not come into contact with a hot surface.
- When disconnecting the appliance from the power socket, always pull the plug, not the power cord. Otherwise, damage to the power cable or the socket may occur.
- Make sure that the mains cord and plug does not come into contact with water or other fluid.

IMPORTANT SAFETY INSTRUCTIONS FOR USING ELECTRICAL EQUIPMENT

- Fully unwind the power cord before use.
- Do not leave the power cord hanging over the edge of a table or counter top or allow it to touch a hot surface or to become tangled up. Do not put heavy objects on the power cord.

- For safety reasons, we recommend to connect the appliance in an independent electrical circuit separated from other appliances. Do not use adapters or extension cords to connect the appliance to a mains socket.
- To prevent electric shock, do not immerse the appliance, its base or the power cord in water or other liquids.
- We recommend that you check your appliance regularly. Do not use the appliance if it is damaged in any way or if the power cord or plug is defective. Any repairs or adjustments must be performed by the nearest Catler authorised service centre.
- Any maintenance other than routine cleaning must be entrusted to an authorised Catler service centre.
- We recommend installing a residual current device (standard safety switches in your power outlet) to provide a higher level of protection when using the appliance. It is recommended that the RCD (with a residual operating current not exceeding 30 mA) be installed in the electrical circuit to which the appliance will be connected. For further expert advice, please contact your electrician.

Instructions are also available at **www.catler.eu**.

MEET YOUR COFFEE MACHINE

COFFEE MACHINE AND ITS ACCESSORIES

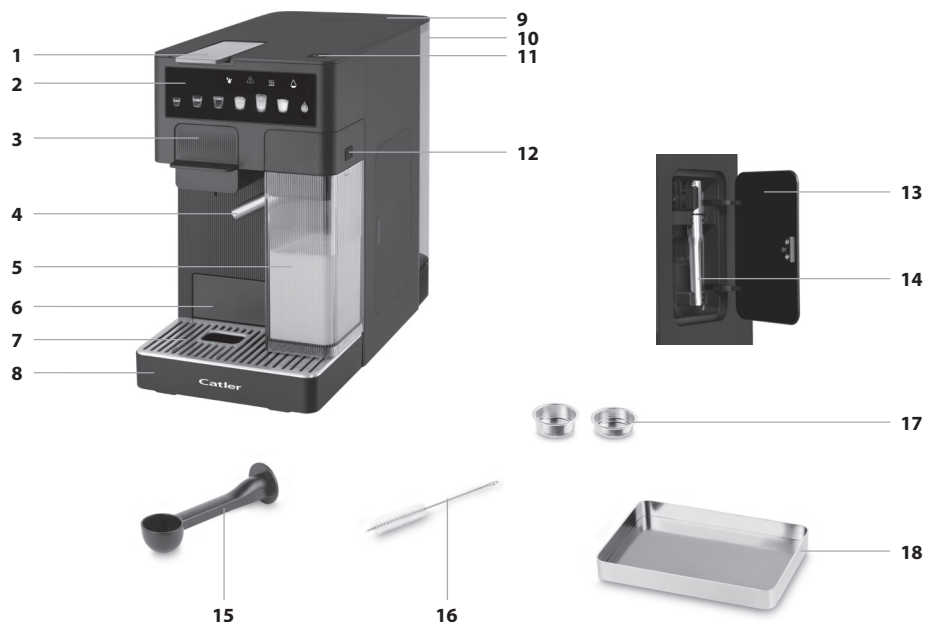

1. Cover
2. Control panel
3. Capsule holder / sieve
4. Milk dispensing jet
5. Milk container
6. Stand for smaller cups
7. Drip tray grill
8. Removable drip tray
9. Lid of the water tank
10. Water tank
11. ⏻ button to switch the coffee machine on/off
12. Button to unfold the milk container
13. Service door
14. Steam jet
15. Measuring cup/tamper
16. Cleaning brush
17. Strainers for ground coffee (for 1 and 2 cups)
18. Tray

CONTROL PANEL

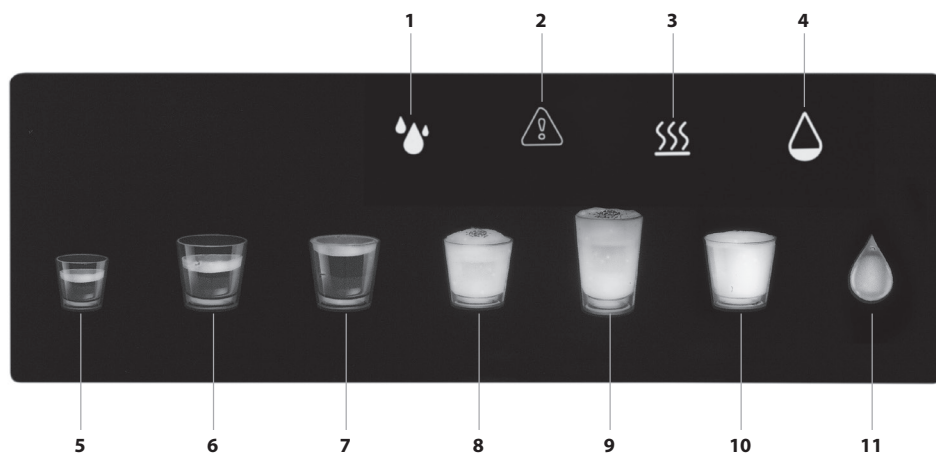

1. Descaling indicator
2. Warning indicator
3. Preheat indicator
4. Low water level indicator in the tank
5. Espresso / small cup button
6. Lungo / medium cup button
7. Americano / large cup button
8. Cappuccino button
9. Latte button
10. Milk frothing button
11. Automatic cleaning button

SUPPLIED HOLDERS

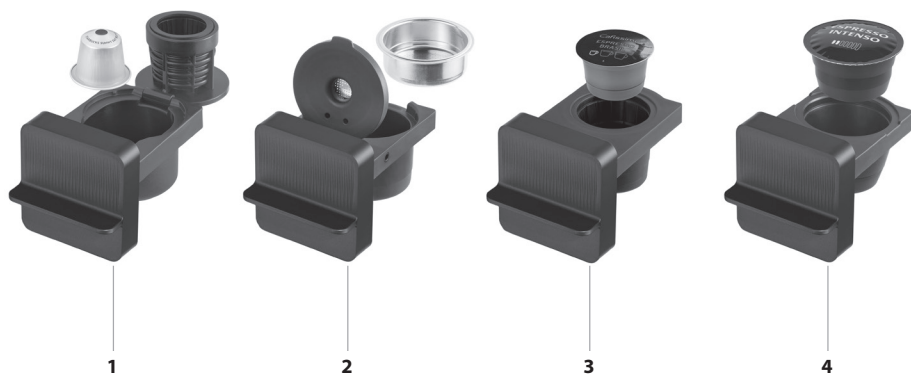

1. **S** size holder, Ø 36 mm, compatible with Nespresso capsules
2. **M** size holder, Ø 44 mm, compatible with Cafissimo / Tchibo capsules
3. **L** size holder, Ø 54 mm, compatible with Dolce Gusto capsules
4. **GR** holder for ground coffee sieve

PREPARATION BEFORE USE

BEFORE FIRST USE

Before first use, remove all packaging and advertising labels/stickers from the appliance.

Place the coffee machine on a flat, firm and stable surface well away from the mains socket. Make sure there is sufficient clearance around the coffee machine (at least 10 centimetres) to ensure proper air circulation.



WARNING!

THE COFFEE MACHINE IS NOT INTENDED FOR USE AS A BUILT-IN APPLIANCE AND MUST NOT BE PLACED IN A CABINET WHEN IN USE.

Remove the water tank, milk container, drip tray with grid, strainers, measuring cup and tray. Wash them in warm water with a little kitchen detergent, rinse and wipe dry. Wipe the outer surface of the machine and the pod holders with a slightly damp cloth. Wipe it dry. Put all the washed parts back into the machine.

FILLING THE TANK

Always make sure that the power cord is disconnected from the mains socket before filling the tank. Always fill the water tank with clean, cold drinking water.

1. Carefully remove the water tank from the back of the machine.
2. Remove the lid and fill with water up to the MAX mark. Put the lid back on.
3. Insert the tank into the coffee machine and push slightly to connect the contacts at the bottom of the tank and in the coffee machine.



WARNING!

THE MAXIMUM TANK CAPACITY IS 1.6 LITRES

OF WATER. DO NOT OVERFILL IT. WHEN FILLING, ALWAYS OBSERVE THE MINIMUM AND MAXIMUM MARKS ON THE TANK. NEVER FILL THE TANK WITH WARM, HEATED OR SPARKLING WATER OR OTHER LIQUIDS SUCH AS MILK. THIS COULD DAMAGE THE APPLIANCE.

NOTE:

Do not leave the water in the tank for more than one day. You should always use fresh water to make quality coffee. Otherwise, the taste of the final beverage may be negatively affected.

You can fill the water tank even when the tank is inserted in the coffee machine. In this case, remove the cap and pour water into the tank. Put the lid back on.



WARNING!

WHEN POURING, TAKE EXTRA CARE NOT TO SPILL THE COFFEE MACHINE OR THE SUPPLY CABLE.

FILLING THE MILK CONTAINER

Fill the milk container if you will be preparing Cappuccino or Latte from the pods. When the milk container is connected, the Cappuccino and Latte buttons on the control panel will light up, but the milk frothing button will be off.

1. Pull the milk container out of the body of the machine.
2. Press the button to disassemble the container and pour fresh cold milk into the container.
3. Fold the container and put it back in the coffee machine. Always make sure that the milk outlet jet points above the drip tray when loading.
4. Select the beverage you want to prepare, and after the coffee is brewed, it will automatically start frothing and dispensing hot milk and foam into the cup.

NOTE:

We recommend using fresh whole milk.

STEAM JET

Fit the steam jet if you are preparing a Cappuccino or Latte from ground coffee. When the steam jet is connected, the milk frothing button on the control panel will light up, but the Cappuccino and Latte buttons will be off.

1. Remove the milk container from the body of the machine and set it aside.
2. Open the service door and remove the steam jet.
3. Insert the steam jet into the coffee machine.

USING THE STAND

If you use a smaller coffee cup, you can slide out the stand.

1. Push the stand slightly inwards to release it, then pull it out.
2. Place the cup on the stand.
3. If you are not going to use the stand, push it into the coffee machine. Press until you hear a click.



USING YOUR COFFEE MACHINE

RINSING THE COFFEE MACHINE

Before using the machine for the first time, or after you have not used it for a long time, you should rinse it to clean the internal pipes and components.

1. Make sure the water tank is full, there is no capsule in the holder and the cover is closed. Place a cup on the grid of the drip tray into which the water will flow.
2. Plug the power cord into the mains socket.
3. Switch on the coffee machine with the  button. The preheat light will illuminate on the display and the machine will start to preheat.
4. Once the preheating is complete, an audible warning sounds and the control panel lights up.
5. Press the brew button (without milk) and the machine starts. The water is pumped into the inner pipe, heated and through the scalding head the coffee dispenses into the container.
6. When the flushing process is complete, an audible alert sounds and the control panel lights up.
7. Empty the cup and the coffee machine is now ready to use.

USING THE COFFEE MACHINE

The coffee machine comes with three capsule holders and one holder for strainer for ground coffee. You will be able to prepare your favourite coffee.



S size holder,

Ø 36 mm, compatible with Nespresso capsules



M size holder,

Ø 44 mm, compatible with Cafissimo / Tchibo capsules



L size holder,

Ø 70 mm, compatible with Dolce Gusto capsules



GR holder for ground coffee sieve

1. Check that there is water in the tank. Refill if necessary.
2. Open the cover and pull out the holder.
3. Insert a suitable capsule into the selected holder.
4. If you use ground coffee, pour it into a sieve and tamp it properly. Then insert into the holder for the ground coffee strainer.



WARNING!

ALWAYS USE THE CAPSULES WITH THE HOLDER THAT IS DESIGNED FOR THE CAPSULE. DO NOT COMBINE CAPSULES AND HOLDERS. THERE IS A RISK OF SERIOUS DAMAGE TO THE HOLDER AND THE COFFEE MACHINE.

5. Put the holder back into the machine and close the cover.
6. Place a cup under the coffee dispenser. Pull out the stand as needed and place the cup on it.
7. Pour fresh cold milk into the container or attach the steam jet.
8. Plug the power plug into the mains socket and press any button to switch the machine on.
9. The preheating process starts. Once the machine is preheated, the control panel lights up.
10. Press the button for the selected beverage and the machine will start. The button of the selected beverage will light up and the coffee preparation will start.
11. The brewing process automatically stops when the pre-set amount of brewed coffee is poured into the cup.
12. Open the cover and pull out the holder. Dispose of the used capsule environmentally according to the manufacturer's instructions. Remove the sieve with the used ground coffee and dispose of the coffee grounds in your home composter.



WARNING!

THE CAPSULE OR STRAINER USED MAY BE VERY HOT. THERE IS A RISK OF BURNS IF HANDLED INCORRECTLY.



WARNING!

DO NOT INSERT YOUR HANDS INTO THE TOP OF THE INTERIOR OF THE MACHINE WHEN THE HOLDER IS REMOVED. THERE IS A SHARP NEEDLE THAT SERVES TO PIERCE THE CAPSULE DURING USE. TAKE EXTRA CARE NOT TO CUT YOURSELF ON IT.

NOTE:

You can cancel the coffee preparation by pressing the button of the beverage you are preparing for a longer time.

NOTE:

When the beverage is finished, the heat indicator light on the control panel may briefly illuminate. This is a normal occurrence. Wait for the buttons on the control panel to light up so you can make another cup of coffee.

PREPARATION OF COFFEE WITH MILK (PODS)

If you will be making coffee with milk from a pod (Cappuccino or Latte), make sure the container is filled with milk and is attached to the machine.

1. Press the coffee drink button and the coffee machine starts.
2. When the pod coffee brewing process is complete, the milk frothing process starts and after a while hot milk and milk foam will flow into the cup.
3. Wait for the milk dispensing process to stop.

When you have finished making a coffee drink with milk, clean the milk dispensing jet and the milk container. We recommend starting the automatic cleaning – see the section “**Automatic Cleaning**” later in the manual.

NOTE:

If you don't use all the milk in the container, take the container out of the machine and store it in the fridge. This way you can store unconsumed milk up to the next day. It is not recommended to store milk for longer.

MANUAL MILK FROTHING

1. Insert the steam jet into the coffee machine (see chapter “**Steam Jet**” in the previous section of the instructions).
2. Pour fresh cold milk into a cup or jug and place it on the grid with the end of the steam jet pointing into the cup.
3. Immerse the steam jet in the milk.
4. Press the milk frothing button briefly and the heating icon will flash on the control panel. This means that the water in the indoor system is heated to steam temperature.
5. The steam discharge starts after approximately 15 seconds. Adjust the angle of the milk cup as needed so that the jet is submerged just below the milk level and the milk starts to circulate in the cup. The milk begins to warm up and increase in volume. Milk froth will start to form on the surface of the milk.
6. When a sufficient amount of milk foam has been created, you can dip the jet deeper to heat the milk.
7. When the bottom of the container is heated to the point that it is hot to the touch, press the milk frothing button for a long time to stop the frothing process.
8. When the steam stops forming, carefully remove the cup. Using a swirling motion, whip the froth into the warmed milk, pour into the prepared coffee and serve.
9. Wipe the steam jet with a slightly dampened sponge and clean it according to the instructions in “**Cleaning the Steam Jet**”.



WARNING!

DURING FROTHING, THE JET MUST ALWAYS BE IMMERSSED. OTHERWISE HOT MILK MAY SPLASH OUT.

AUTOMATIC SHUTDOWN

The coffee machine is equipped with an automatic shut-off function after 9 minutes of inactivity. Press any button to put the machine into standby mode.

MANUAL SHUTDOWN

If you are no longer using the machine, press the  button and the machine will switch off.

Table of beverage volumes

Beverage	Volume
Espresso	50 ml
Lungo	100 ml
Americano	150 ml
Cappuccino	120 ml of milk 50 ml of coffee
Latte	220 ml of milk 50 ml of coffee

NOTE:

The above volumes are the default volumes in the coffee machine settings. The amount of milk and milk foam will depend on the type of milk used and its starting temperature.

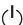
REFILLING THE WATER TANK

If the low water light comes on while the machine is in use, the water tank needs to be refilled.

1. Remove the tank lid.
2. Pour clean water into the tank.
3. Put on the tank lid.

ADVANCED COFFEE MACHINE SETTINGS

COFFEE VOLUME ADJUSTMENT

The coffee maker allows you to adjust the coffee volume setting to your personal preferences. The volume of each coffee can be adjusted. Follow these steps:

Place a cup under the coffee dispenser. Press and hold the button for the selected drink until a short beep sounds. Preparation starts and the machine starts to dispense coffee. Keep the button pressed until the desired volume of coffee is poured into the cup. Then release the button. The coffee volume can be adjusted from 25 ml to 200 ml.

A sound alert will be heard.

NOTE:

The button for the selected beverage must be held for at least 3 seconds for the machine to enter the coffee volume setting mode.

NOTE:

The button for the selected beverage must be held for at least 3 seconds for the machine to enter the coffee volume setting mode.

RESTORING FACTORY DEFAULT

When you restore the factory settings, all the settings you have made will return to the factory defaults.

Press and hold the Espresso and Lungo coffee buttons for 5 seconds when the machine is switched on and ready to make coffee. A sound alert will be heard. All control buttons will flash for 5 seconds. The initial coffee volume is restored.

MILK VOLUME ADJUSTMENT

The coffee maker allows you to adjust the milk volume setting to your personal preferences. The milk volume for Cappuccino and Latte can be adjusted as follows:

Place a cup under the coffee dispenser. Press and hold the button for the selected beverage (Cappuccino or Latte) until a short beep sounds. Wait for the preparation and dispensing of hot milk and milk foam to start. Keep the button pressed until the desired volume of milk is poured into the cup. Then release the button. The volume of milk can be adjusted for the duration of the dispensing period, from 10 to 60 seconds. A sound alert will be heard.

CARE AND CLEANING

Before cleaning the appliance, always disconnect the plug of the power cord from the mains socket and let it to cool down properly.

Clean the coffee machine after each use.



WARNING!

DO NOT WASH THE APPLIANCE, POWER CORD AND PLUG UNDER RUNNING WATER, AND DO NOT SUBMERGE THEM IN WATER OR ANY OTHER LIQUID.



CAUTION!

DO NOT USE SHARP OBJECTS, CHEMICALS, THINNERS, PETROL OR OTHER SIMILAR SUBSTANCES. UNDER NO CIRCUMSTANCES SHOULD THE APPLIANCE BE CLEANED WITH A STEAM CLEANER.

sieve with the used ground coffee and dispose of the coffee grounds in your home composter.

2. Rinse the holder and the used strainer under warm running water and wipe dry with a clean cloth.
3. After removing the holder, wipe the underside of the interior of the coffee machine with a slightly damp sponge and a clean cloth.
4. Put the holder back into the coffee machine.



WARNING!

DO NOT INSERT YOUR HANDS INTO THE TOP OF THE INTERIOR OF THE MACHINE WHEN THE HOLDER IS REMOVED. THERE IS A SHARP NEEDLE THAT SERVES TO PIERCE THE CAPSULE DURING USE. TAKE EXTRA CARE NOT TO CUT YOURSELF ON IT.

AUTOMATIC CLEANING

Always perform automatic cleaning after using the milk container or steam jet to remove milk residue.

1. Place a mug or smaller bowl under the container jet or steam jet.
2. Press the automatic cleaning button.
3. A short cleaning of the internal system will start and the water will flow into the cup.
4. Allow the coffee machine to complete the automatic cleaning process.

HOLDER AND STRAINER

1. Open the cover and pull out the holder. Dispose of the used capsule environmentally according to the manufacturer's instructions. Remove the

DRIP TRAY AND GRATE

1. Carefully remove the drip tray, remove the grid and pour out the contents of the tray.
2. Wash the tray and grid in warm water with a little kitchen detergent and rinse with clean water. Wipe it dry.

WATER TANK

1. Remove the water tank from the coffee machine and pour out the water.
2. Rinse the tank with clean, warm water and wipe dry.

COFFEE MAKER

Wipe the coffee machine with a soft, slightly dampened sponge and wipe dry with a clean cloth.

CLEANING THE MILK CONTAINER

We recommend cleaning the milk container regularly after each use. Otherwise, milk residues could accumulate in the internal system, resulting in bacteria that could cause unpleasant odours and ultimately serious health problems.

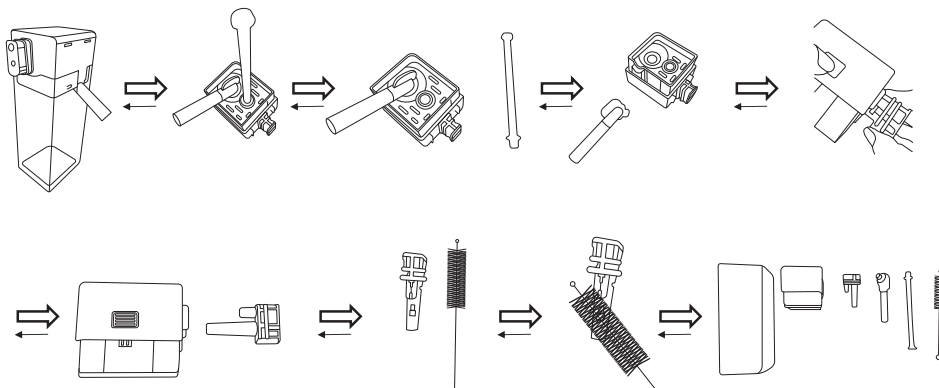

1. Remove the container from the coffee machine.
2. Press the button and unfold the container. Pour the remaining milk into a suitable container and refrigerate.
3. Pull out the silicone tube and the milk dispensing jet.
4. Press the button again to disassemble the container and pull out the adapter.
5. Use a cleaning brush to clean the adapter, jet and hose.
6. Wash all parts thoroughly in warm water with a little kitchen detergent. Rinse with clean water and wipe dry, or allow to dry freely.

When assembling the milk container, reverse the procedure.

CLEANING THE STEAM JET

We recommend cleaning the steam nozzle regularly after each use. Otherwise, milk residues could accumulate in the internal system, resulting in bacteria that could cause unpleasant odours and ultimately serious health problems.

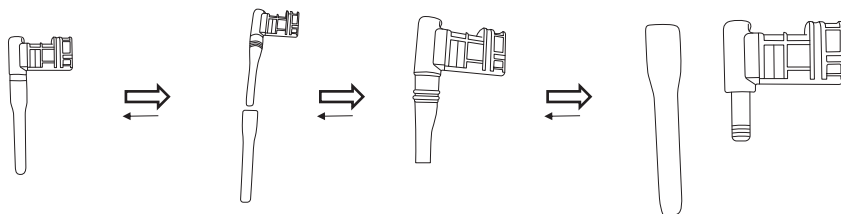

1. Pull the steam jet out of the coffee machine.
2. Turn the steam jet clockwise to the open lock symbol to disassemble the steam jet.
3. Clean both parts of the steam jet with a cleaning brush.

4. Rinse under clean running water to remove milk residue.

Fold the steam jet in the opposite way. Check that it is correctly seated.

If the steam jet hole becomes blocked, use a thin object such as a pin to remove the blockage in the steam jet hole.

DESCALING

Mineral deposits that occur in the water may settle in the internal circuit of the coffee machine during use. These can adversely affect its operation, energy consumption, coffee preparation and final taste. It is therefore important to carry out the descaling process regularly to remove these deposits. When the descaling light comes on, the machine must be descaled. The indicator light usually comes on after 50 l of water has been dispensed or after 500 brewing cycles. For descaling, use special descaling agents that are designed for this type of coffee machine.

1. Make sure the coffee machine is switched off and unplugged from the mains socket.
2. Prepare 1 litre of descaling solution according to the instructions on the packaging and pour it into the water tank.
3. Attach the milk container to the coffee machine.
4. Plug the plug into the mains socket and switch on the coffee machine. Let it preheat.
5. Place a smaller bowl under the coffee dispenser.
6. Press and hold the Auto Clean button for 5 seconds until the Espresso button lights up.
7. Press the Espresso button to start the first descaling phase.
8. During the first phase, the heated descaling solution will flow into the bowl from the dispensing opening and from the nozzle of the container. The solution

discharge will always be interrupted briefly as the solution is pumped into the internal piping and subsequently heated. The automatic cleaning button will flash throughout the descaling process.

9. At the end of the first descaling phase, a short audible warning sounds and the Lungo button lights up.
10. Press the Lungo button to start the second descaling phase.
11. Let the coffee machine finish the second phase.
12. When the descaling process is complete, the coffee machine will turn itself off.

If the solution in the tank runs out during the descaling process, refill the tank with clean water. It is usually at the end of the first phase.

Check the solution in the bowl regularly so that you can pour out the solution if necessary. Be careful not to scald yourself when pouring the solution as it may be hot. Remove, empty and rinse the water tank and drip tray. Wipe it dry.



STORAGE

Before storing, make sure that the appliance is clean, dry and completely cooled. Store it in a well-ventilated dry place out of reach of children and animals.

TROUBLESHOOTING

This chapter describes the most common problems you may encounter while using this appliance. If your problem is not listed here or is listed and persists, stop using the appliance, unplug the power cord from the power outlet and contact an authorised service centre.

UNDER NO CONDITION SHOULD YOU REPAIR OR DISASSEMBLE THE APPLIANCE YOURSELVES. THE APPLIANCE CONTAINS NO USER SERVICEABLE PARTS.

Problem	Cause	Solution
The coffee machine didn't switch on.	The power plug is not plugged into the mains socket.	Plug the power plug into the mains socket.
	You did not press the  button.	Press the  button to turn the coffee machine on.
Coffee is not dispensing.	There is no water in the tank.	Refill the water tank.
The coffee is not hot enough.	The coffee cup was cold.	Preheat the cup before making coffee.
	The coffee machine is clogged with limescale.	Perform the descaling process.
	The coffee machine is cold.	Wait for the coffee machine to preheat and switch on the coffee machine without the capsule to allow the hot water to heat the internal components of the coffee machine.
There is water on the plate around the coffee machine.	Water is leaking from the tank.	Check that the tank is installed correctly.
	The drip tray is full.	Pour the water out of the drip tray.
The cover cannot be closed.	The holder is not correctly positioned in the coffee machine.	Push the holder into the coffee machine.
The warning light  is on.	The holder is not correctly positioned in the coffee machine.	Open the cover and slide the holder into the coffee machine. Then close the cover.

INSTRUCTIONS AND INFORMATION ON DISPOSAL OF USED PACKAGING MATERIAL

Dispose of used packaging material at the location designated by the municipality for waste disposal.

DISPOSAL OF USED ELECTRICAL AND ELECTRONIC EQUIPMENT



This symbol on products or original documents means that used electric or electronic products must not be added to ordinary municipal waste. For proper disposal and recycling of these products, deliver them to designated collection points. Alternatively, in some European Union states or other European countries the products can be returned to the local retailer when buying an equivalent new product. By properly disposing of this product, you help preserve valuable natural resources and contribute to preventing potential negative impacts on the environment and human health resulting from improper waste disposal. For further details, contact your local authorities or the nearest collection point. Fines may be imposed for improper disposal of this type of waste in accordance with national regulations.

For Business Entities in European Union States

To dispose of electric or electronic equipment, request necessary information from your retailer or supplier.

Disposal in Other Countries Outside the European Union

This symbol is valid in the European Union. To dispose of this product elsewhere, request necessary information on the correct disposal method from local authorities or your retailer.



This product meets all the basic requirements of the applicable EU directives.

The text, design and technical specifications may be changed without prior notice and we reserve the right to make these changes.

The original version is in the Czech language.

Manufacturer's address: FAST ČR, a.s., U Sanitasu 1621, Říčany CZ-251 01

NOTES